

# **EN** Manual for Solight Smart WiFi Water Leak Detector 1D100W

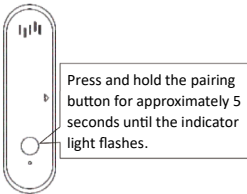

## DESCRIPTION OF EQUIPMENT

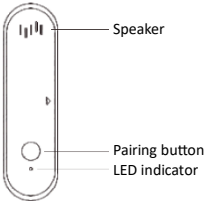

## TECHNICAL PARAMETERS

Batteries	2x AAA (1.5V) alkaline batteries
Quiet current	$\leq 18\mu\text{A}$
Alarm current	$\leq 100\text{mA}$
Volume	80dB (up to 1m)
Working temperature	$-10^{\circ}\text{C} \sim 55^{\circ}\text{C}$
Working humidity	10% ~ 90%RH
WIFI	IEEE 802.11 b/g/n 2.4GHz
The device is intended for indoor use	

## USE

1. Push the back cover upwards and remove the cover, then insert the battery.



2. Insert batteries according to polarity. The indicator light will flash when the batteries are inserted.

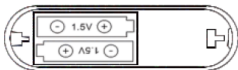

3. Download the Smart Life mobile app via Google Play for Android devices or the App Store for iOS devices.



4. First turn on Bluetooth on your mobile phone, open the Smart Life app and select "+" then hold the pairing button for about 5 seconds until the indicator starts flashing.

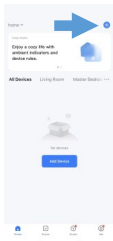
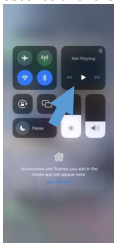

5. Then the mobile app will display "Discovering devices". Once found, press "Go to add", select the WiFi network and enter the password for it. The device will automatically connect.

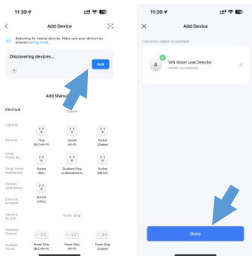

6. After a successful connection:

**Figure 1:** Status of the water leak detector "Normal", press the "Smart" button to set the automatic connection with other devices, press the "Set" button to make other settings.

**Figure 2:** Water leak detector status "Alarm", press the "Mute" button to turn off the alarm sound.

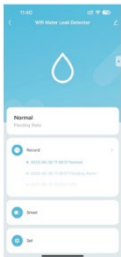

①

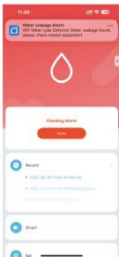

②

## 7. FUNCTIONS

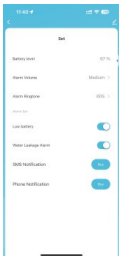

### Alarm Volume

- High
- Medium
- Low
- Mute

### Alarm Ringtone (Alarm Time)

- Can be set from 30s to 180s

## **8. DEVICE SHARING**

For example, you can share the device with family members so they can also monitor the alarm status.

## **9. INTELLIGENT INTERCONNECTION**

There are options to connect the alarm to the Smart Life/Tuya automation processes

## **10. BATTERY LIFE**

Battery life is determined by the quality of the batteries and the frequency with which the detector will be triggered.



The product has been issued with a CE Declaration of Conformity and a Declaration of Performance in accordance with the applicable regulations. On request from the manufacturer: [info@solight.cz](mailto:info@solight.cz) or download [www.solight.cz](http://www.solight.cz)